

# RESECTION 2

$$\frac{9,695.0951}{10,229.6195}$$

2 B

$$\frac{8,587.8655}{11,419.8776}$$

3 C

$$\frac{8,220.4485}{8,805.5699}$$

1 A

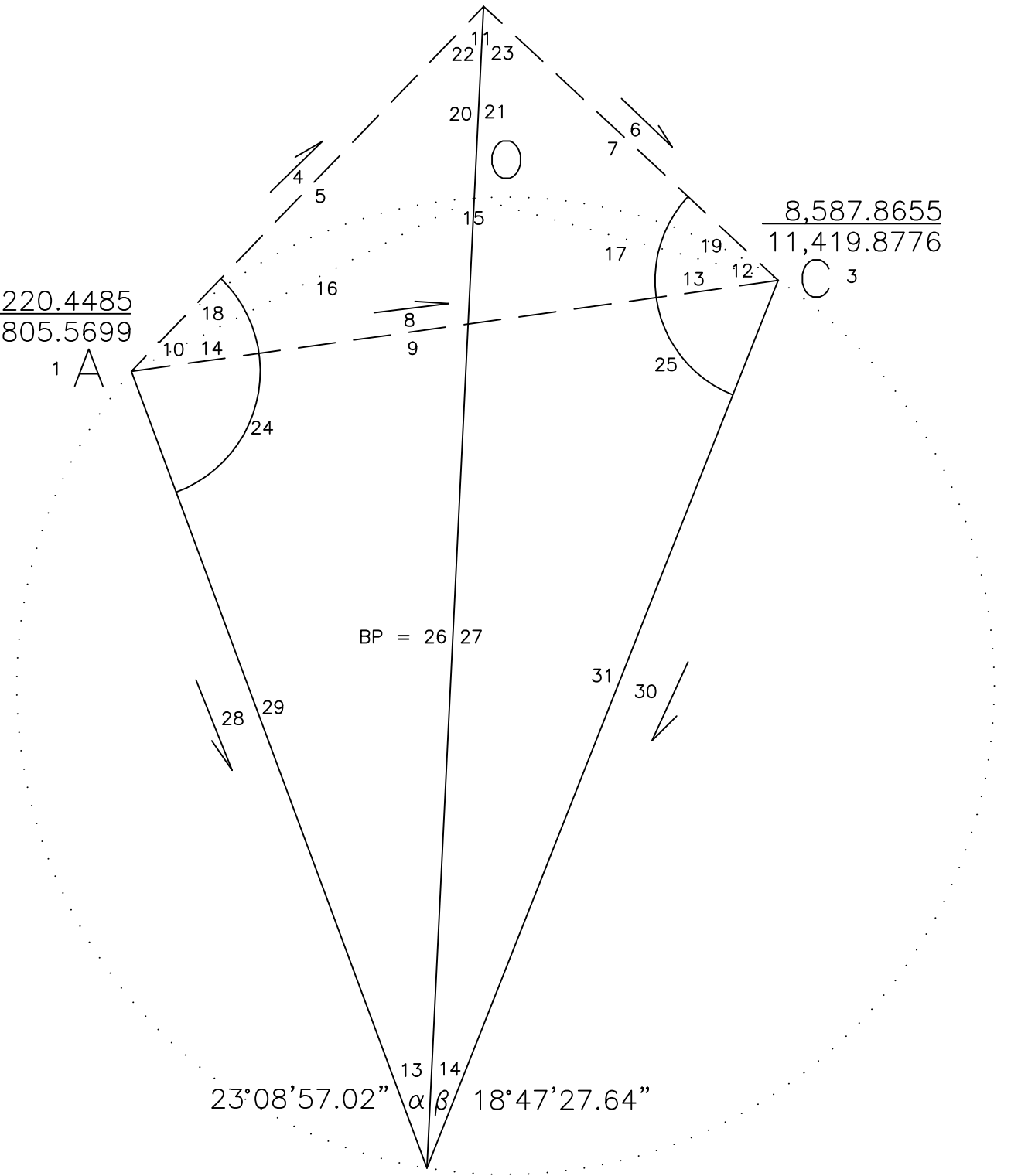

BP = 26 27

23°08'57.02"  $\alpha$   $\beta$  18°47'27.64"

32 P 33